

WEST SUSSEX COUNTY COUNCIL
((CRAWLEY BOROUGH)(PARKING PLACES AND TRAFFIC REGULATION)
(CONSOLIDATION) ORDER 2010)
(THE BOULEVARD & EXCHANGE ROAD AMENDMENT)
ORDER 2023

CRAWLEY: LOCATION OF WAITING RESTRICTIONS

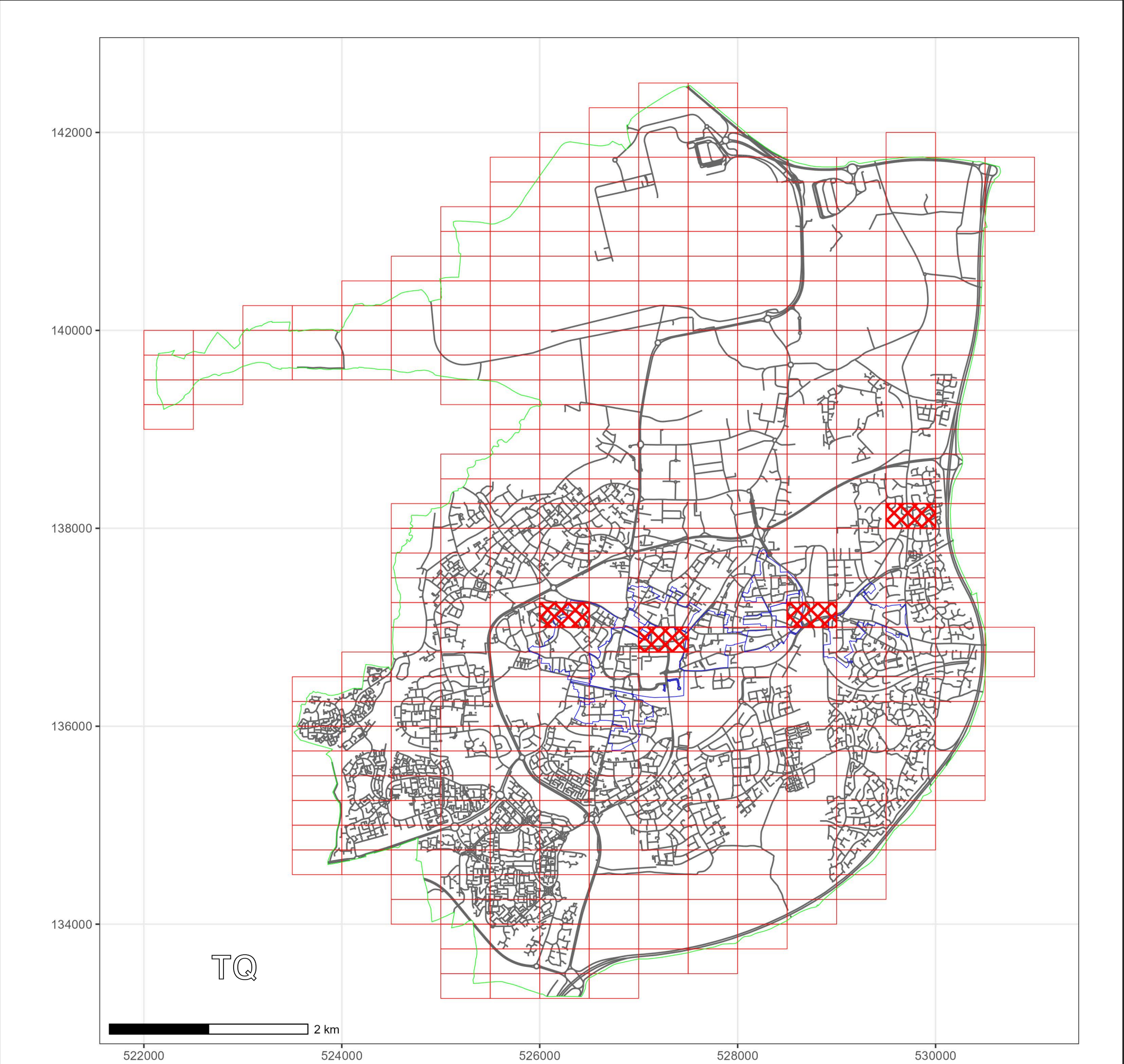

KEY:

OS.TILE GRID

PARKING TILE GRID

LOCATION OF WAITING RESTRICTIONS

PARISH BOUNDARY

ROAD NETWORK

CONTROLLED PARKING ZONE BOUNDARY

Key for Waiting Restrictions

All areas over which the provision of the orders apply are defined by the shaded areas as shown on the following plans plus a contiguous area not indicated on the plans of verge and/or footway between the carriageway edge and the highway boundary. The plans in this schedule are based upon grid references of the Ordnance Survey National Grid defined by the OSGB 36 triangulation.

Prohibition of Waiting

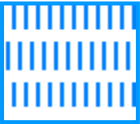
101		check	No waiting at any time
158		pat 046	No waiting 9.00am-5.00pm Mon-Sat except bank holidays

Prohibition of Loading

225		usgs401	No waiting at any time, No loading and unloading 10.30am-4.00pm Mon-Sat
-----	---	---------	---

Residents Parking

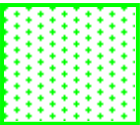
512		usgs503	Residents' and Visitors' permit holders only 9.00am-5.00pm Mon-Sat except bank holidays
516		usgs721	Residents' and Visitors' permit holders only 9.00am-5.00pm Mon-Fri except bank holidays

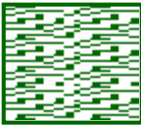

Shared Residents Parking & Free Limited Waiting

614		pat019	Residents' and Visitors' permit holders and Limited waiting for 2hrs No return within 2hrs for non-permit holders 9.00am-5.00pm Mon-Sat except bank holidays
-----	---	--------	--

Free Limited Waiting

740		usgs401	Waiting limited to 2hrs No return within 2hrs 9.00am-5.00pm Mon-Sat except bank holidays
-----	--	---------	--

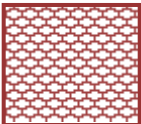
Specified Vehicles

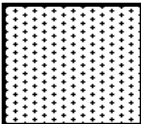
810		usgs503	Loading bay-Goods vehicles only at any time
830		check	Disabled persons vehicles at any time
844		usgs721	No stopping at any time except taxis

WEST SUSSEX COUNTY COUNCIL
((CRAWLEY BOROUGH) (PARKING PLACES AND TRAFFIC REGULATION)
(CONSOLIDATION) ORDER 2010)
(THE BOULEVARD & EXCHANGE ROAD AMENDMENT) ORDER 2023

West Sussex County Council in exercise of their powers under Sections 1 (1) 2 (1) and (2), 4 (2), 45, 46, 49 and 53 and Part IV of Schedule 9 of the Road Traffic Regulation Act 1984 "the Act" as amended and of all other enabling powers and after consultation with the chief officer of police in accordance with Part III of Schedule 9 to the Act hereby make the following Order:-

1. This Order shall come into operation on the 2nd day of May 2023 and may be cited as "West Sussex County Council ((Crawley Borough) (Parking Places and Traffic Regulation) (Consolidation) Order 2010) (The Boulevard & Exchange Road Amendment) Order 2023."
2. The "West Sussex County Council (Crawley Borough) (Parking Places and Traffic Regulation) (Consolidation) Order 2010" is hereby amended by the deletion from it of the plans specified in the First Schedule to this Order and the substitution of the plans attached in the Second Schedule to this Order.

FIRST SCHEDULE
Plans to be deleted

TQ2637SWS (Sheet Issue No. 5)
 TQ2736NWN (Sheet Issue No. 5)
 TQ2837SES (Sheet Issue No. 6)
 TQ2938SES (Sheet Issue No. 1)

SECOND SCHEDULE
Plans to be substituted
(as attached)

TQ2637SWS (Sheet Issue No. 6)
 TQ2736NWN (Sheet Issue No. 6)
 TQ2837SES (Sheet Issue No. 7)
 TQ2938SES (Sheet Issue No. 2)

For and on behalf of WEST SUSSEX COUNTY COUNCIL

Authorised Signatory: 

NAME: Rebecca Caney

DATE MADE: 25th April 2023

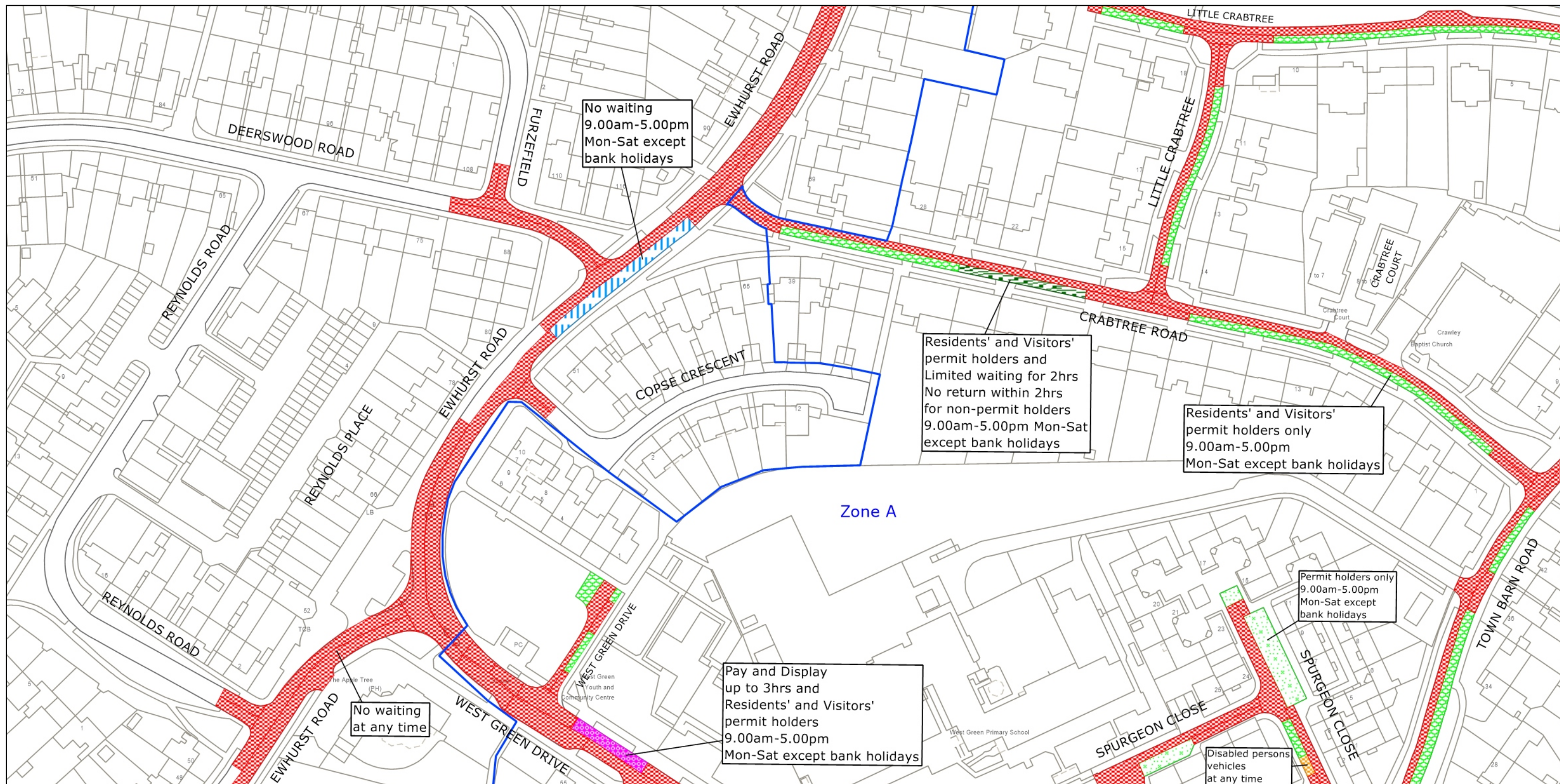

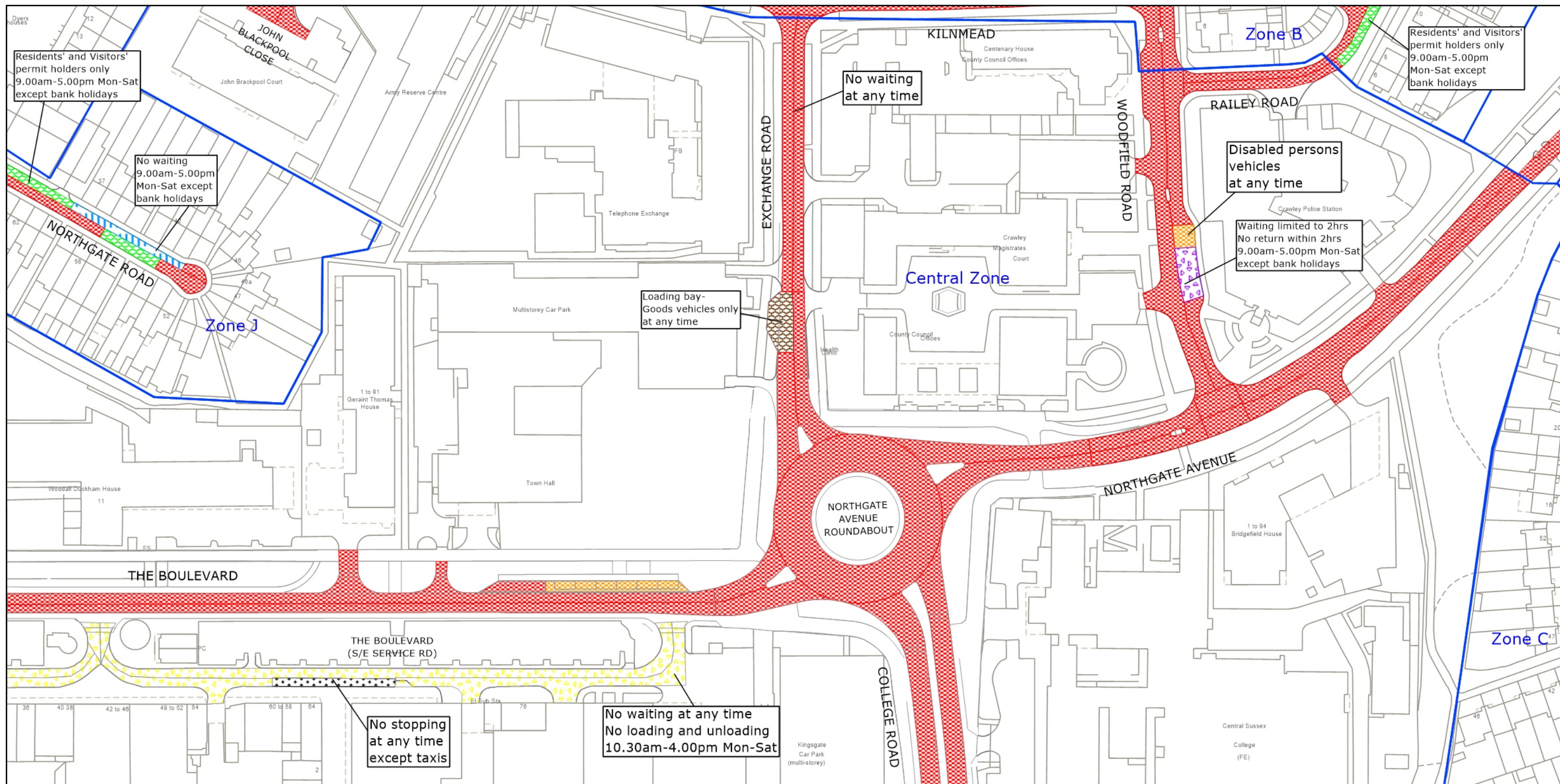

West Sussex County Council
Highways & Transport
The Grange
Tower Street
Chichester
West Sussex
PO19 1RH

CRAWLEY BOROUGH: NORTHGATE & WEST GREEN AND
THREE BRIDGES WARDS

WAITING RESTRICTIONS

Reproduced from or based upon 2023 Ordnance Survey mapping with permission of the Controller of HMSO (c) Crown Copyright reserved.
Unauthorised reproduction infringes Crown copyright and may lead to prosecution or civil proceedings West Sussex County Council Licence No. 100018485



TILE REF NO:
TQ2736NWN

SHEET ISSUE NO 6
SHEET ACTIVE FROM - 02.05.2023



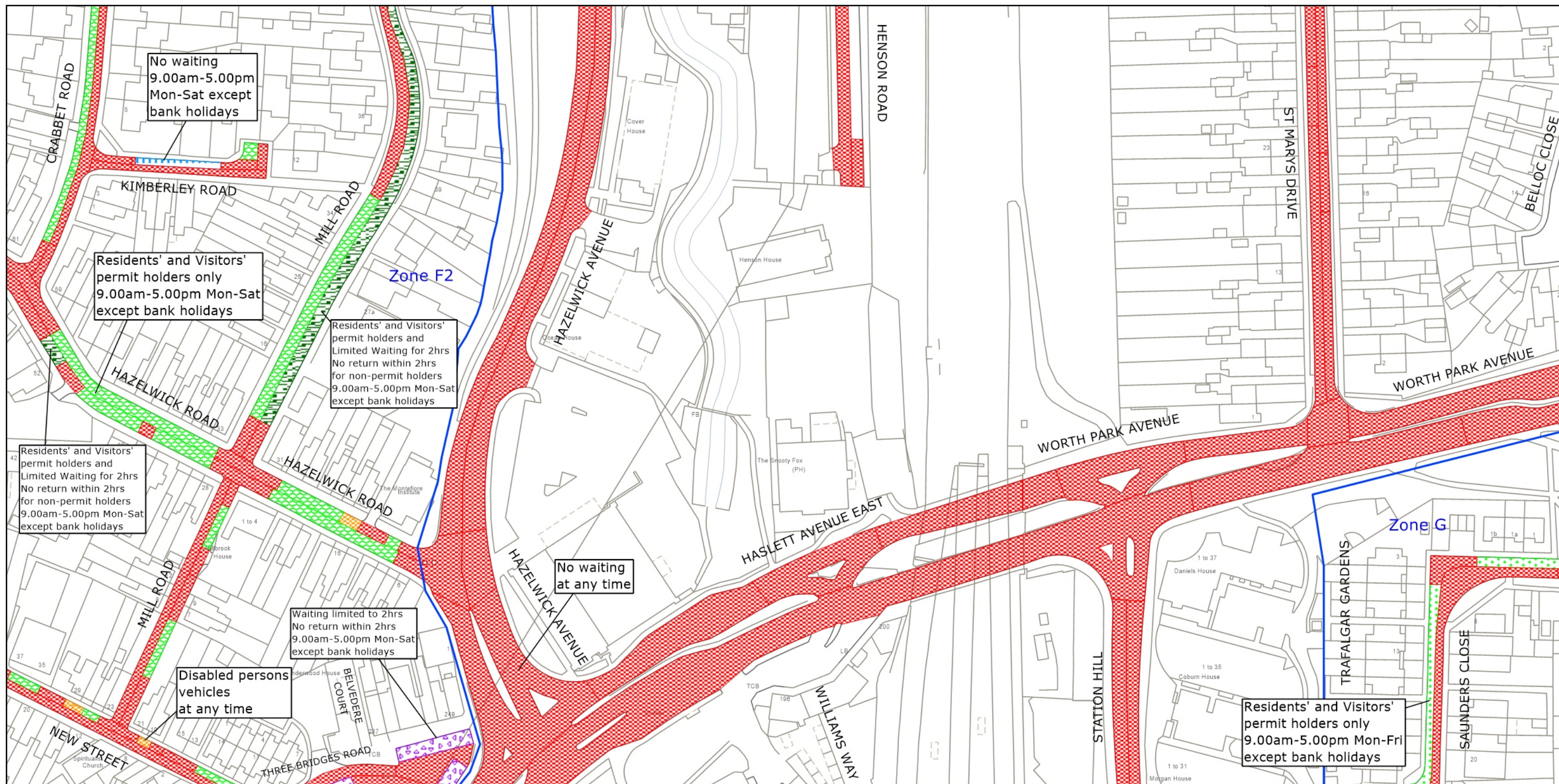

SCALE:
1:1250
at A3 size

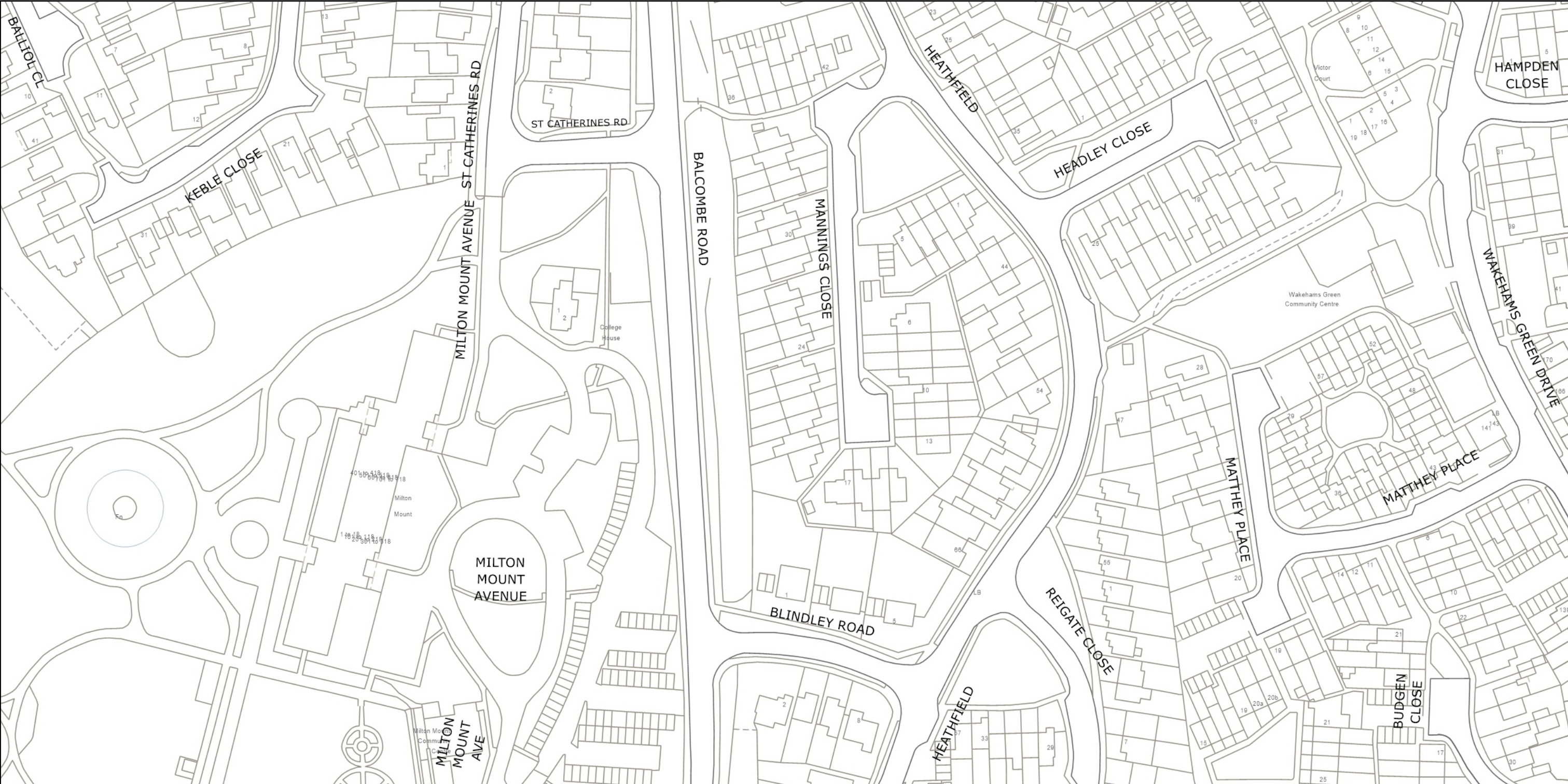

 <p>west sussex county council</p>	<p>West Sussex County Council Highways & Transport The Grange Tower Street Chichester West Sussex PO19 1RH</p>	<p>CRAWLEY BOROUGH: POUND HILL NORTH & FORGE WOOD, POUND HILL SOUTH & WORTH, AND THREE BRIDGES WARDS</p> <p>WAITING RESTRICTIONS</p>	<p>TILE REF NO: TQ2837SES</p> <p>SHEET ISSUE NO 7 SHEET ACTIVE FROM - 02.05.2023</p>	<p>N</p>  <p>SCALE: 1:1250 at A3 size</p>
---	--	--	--	--

Reproduced from or based upon 2023 Ordnance Survey mapping with permission of the Controller of HMSO (c) Crown Copyright reserved.
Unauthorised reproduction infringes Crown copyright and may lead to prosecution or civil proceedings West Sussex County Council Licence No. 100018485



	<p>West Sussex County Council Highways & Transport The Grange Tower Street Chichester West Sussex PO19 1RH</p>	<p>CRAWLEY BOROUGH: POUND HILL NORTH & FORGE WOOD WARD</p> <p>WAITING RESTRICTIONS</p>	<p>TILE REF NO: TQ2938SES</p> <p>SHEET ISSUE NO 2 SHEET ACTIVE FROM - 02.05.2023</p>	<p>N</p>  <p>SCALE: 1:1250 at A3 size</p>
--	--	--	--	--

Reproduced from or based upon 2023 Ordnance Survey mapping with permission of the Controller of HMSO (c) Crown Copyright reserved.
Unauthorised reproduction infringes Crown copyright and may lead to prosecution or civil proceedings West Sussex County Council Licence No. 100018485